



IN A

Nutshell

No. 110

Official community newsletter of the City of Walnut Creek

JANUARY/FEBRUARY 2004

WC to submit 3rd request for library funding

Despite its second setback in trying to secure state funds to build a new downtown library, the City will give it a third and final try in January.

Walnut Creek has one last chance after it was turned down again by the State Library Construction Board on Oct. 28 in its bid for \$17.5 million in voter-approved library construction grant funds.

The state panel doled out \$110 million to 16 cities on a 65 percent state/35 percent local matching fund basis.

It was the second time the City had applied for funds to replace the aging and undersized library at 1644 No. Broadway with a state-of-the-art, 41,800-square-foot facility. The City was first passed over for a state grant in December 2002, when \$130 million was allocated to 13 cities.

The City Council has earmarked \$17 million in general fund monies for the project, which will include a 374-space parking garage and a public plaza on the current library and tennis court sites.

Walnut Creek officials must submit its final application for state funding by Jan. 16 to be considered for the third round of grants, which will total \$92 million.

The state board is expected to make its final grant allocations in early fall 2004.



Having a ball at Alma Park

Walnut Creek brothers Michael Hirsch, 3, and Andrew Hirsch, 6, had fun kicking balls to celebrate the opening of Alma Park on Nov. 22. The two-acre downtown oasis was dedicated by City officials as the City's 19th park. It is nestled among several high density housing developments between Olympic Boulevard and Botelho Drive and features decorative arbors, benches, and crisscrossing paths over rolling lawns. Alma Park was created for the City by developer Steve Seely, who built the adjacent Ivy Hill Apartments and Regent on the Park condominium complex. The public may access Alma Park via a walkway at the corner of So. California and Olympic boulevards.

Skate park to land at Heather

Skaters of all ages will get their wish later this year when the City opens a new skate park at Heather Farm Park.

The City Council eliminated the final obstacle to the 14,000-square-foot facility on Nov. 4 when it voted unanimously to approve a revised Heather Farm Park

Master Plan, which places the skate park at the southeast corner of Marchbanks Drive and Heather Drive, across from Clarke Swim Center.

City staff had an initial design meeting with skate park enthusiasts on Dec. 10 and

SKATE PARK, see page 3

State impasse over VLF means big losses for WC

The controversy over the tripling of the state's motor vehicle license fee, or VLF, and the subsequent repeal of that action by California's new governor has obscured the fact that the VLF is an essential revenue source for the City of Walnut Creek and every other city and

county in California.

By state law, most VLF revenues are allocated to cities and counties. Walnut Creek receives \$3.8 million annually from VLF revenues, which represents about 8.4 percent of the City's operating budget.

The VLF was created in 1935 as a

uniform statewide vehicle tax. It is an annual fee based on the vehicle's current value. From 1948 to 1998, the VLF tax rate was 2 percent.

In 1998, when the state was enjoying a large budget surplus, Governor Pete

VLF, see back page

City Event Calendar

January

1
New Year's Day
City offices closed

19
Martin Luther King Day observance
City offices closed
Ceremony at noon
Civic Park assembly hall
(See *What's Happening*)

February

16
Presidents' Day observance
City offices closed

City Meeting Calendar

City Council 
Jan. 6, 20; Feb. 3, 17
7 p.m.
City Hall, 1666 N. Main St.

Planning Commission
Jan. 15, 29; Feb. 12, 26
7:30 p.m.
City Council chamber

Arts Commission
Jan. 20, Feb. 17
4:30 p.m.
Leshner Center for the Arts

Transportation Commission
Jan. 15, Feb. 19
7:30 p.m.
City Council chamber

Design Review Commission
Jan. 7, 21; Feb. 4, 18
City Council chamber

Park, Rec & Open Space Commission
Jan. 5, Feb. 2
7 p.m., City Council chamber

TV City Council meetings are televised live on Comcast Channels 6 and 26 (unincorporated), and on Astound Channel 29. They are repeated the following Saturday at 1 p.m. on all.

TV *Walnut Creek Currents*, a City-produced 10-minute video digest on City activities and services: Comcast Channels 6 and 26 — Daily at 6 a.m., 9 a.m., noon, 3 p.m., and Wed. at 7:30 p.m. Astound Ch. 29 — 7 p.m. every day but Tuesday

Bubbles, spheres take shape in Bedford Gallery exhibition

Inflatable things of all kinds can be found in *Thin Skin: The Fickle Nature of Bubbles, Spheres, and Inflatable Structures*, an exhibition that features amazing, adventurous, and humorous art by a distinguished international roster of artists that runs through Feb. 15 at Bedford Gallery.

Thin Skin is a traveling exhibition organized and circulated by Independent Curators International (ICI), New York.

Bedford Gallery is in the Dean Leshner Regional Center for the Arts at 1601 Civic Dr. Admission is \$3, general; \$2, ages 12-17; free, under 12. For hours, call 295-1417.



'Attempting to Deal with Time and Space,' 1997, Annika vom Hausswolff

What's Happening

Martin Luther King Day observance

"Celebrating Diversity" will be the theme of the City's annual Martin Luther King Day Service on Monday, Jan. 19 at noon in the Civic Park Community Center assembly hall, 1375 Civic Dr. This public event is presented by the Interfaith Council of Contra Costa County, in cooperation with the City of Walnut Creek. For more information, contact Rev. David Sammons at 934-3135.

Time to recycle your Christmas tree

Pleasant Hill Bayshore Disposal will collect your unwanted Christmas tree for composting the week of Jan. 12-16. Simply leave your tree at the curbside on your regular trash collection day. Remove ornaments, tinsel, and other trimmings. Don't leave stands — metal or wood — on the tree; it will not be taken otherwise. Also, don't leave artificial or flocked trees. Call 603-1144 for details.



Appraisal event at Gardens at HF Feb. 29

Find out the monetary value of your treasures from professional appraisers at the annual Antique and Collectibles Appraisal Event on Sunday, Feb. 29, 1 to 6 p.m. at the Gardens at Heather Farm, 1540 Marchbanks Dr., Walnut Creek. The cost for admission and having up to three items appraised is \$15, and there's a \$5 charge for each additional item. The event benefits the Gardens at Heather Farm, a nonprofit organization that promotes an appreciation of ecology and horticulture through its programs and demonstration gardens. Call 947-1678 or go to www.gardenshf.org.

Correction

The illustration of "Where your property tax dollar goes . . ." in the last issue of the *Nutshell* should have indicated that Contra Costa County, libraries, and flood control receive 16.7 cents, schools receive 53.6 cents, and special districts receive 20.3 cents. The City of Walnut Creek receives 9.3 cents of each property tax dollar.



Walnut Creek's 2003 City Employees of the Year: Roselyn Taormina, left, and Sue Garcia

2003 City Employees of the Year honored

City Manager Mike Parness announced Roselyn Taormina and Sue Garcia as co-recipients of the 2003 Employee of the Year Award. The award, created in 1989, honors those staff members who exemplify excellence in the organization. Roselyn, an Accountant II in the Finance Division, joined the staff in 1999. She was instrumental in implementing an improved financial reporting program that was recognized nationally. Sue, the Services Manager for the Police Department, is a 25-year veteran who has been responsible for coordinating the "Every 15 Minutes" DUI educational programs at Walnut Creek high schools.

Wardrobe for Opportunity

Wardrobe for Opportunity, a non-profit organization supported with grants from the City of Walnut Creek, provides free business clothing and career support to women in transition. Walnut Creek residents are invited to make an appointment for a one-hour personal shopping experience Monday-Saturday by calling 935-2146, x. 11.

Walnut Creek Currents goes prime time

Walnut Creek Currents, the City's 10-minute video digest of activities and programs, can now be seen Wednesdays at 7:30 p.m. on Comcast Cable Ch. 6 and every night (except Tuesday) at 7 p.m. on Astound Cable Channel 29. Comcast Ch. 6 also carries it daily at 6 a.m., 9 a.m., noon, and 3 p.m.

Skate park

From front page

scheduled two more meetings on Jan. 7, 6-9 p.m. at Heather Farm Park Community Center, 301 N. San Carlos Dr., and on Feb. 2, 6-7 p.m., City Council Chamber at City Hall, 1666 N. Main St. (to be followed by a project presentation to the Park, Recreation & Open Space Commission). Check the realwc.org website for updates on the skate park.

The Skate Park Task Force hopes to have the final design ready by spring so construction can begin in late summer and be completed in late fall.

The park master plan update, which was recommended by the City's Park, Recreation & Open Space Commission last July, also calls for two new lighted basketball courts, a new and larger group picnic area to take the place of the equestrian center, additions to the garden center, and new public pathways and piers at the lake.

This is the third revision of the original 1969 master plan for Heather Farm Park.

Other elements of the revised plan include additional swim center parking, additional trees throughout the park and other landscaping.

Although work will begin soon on the

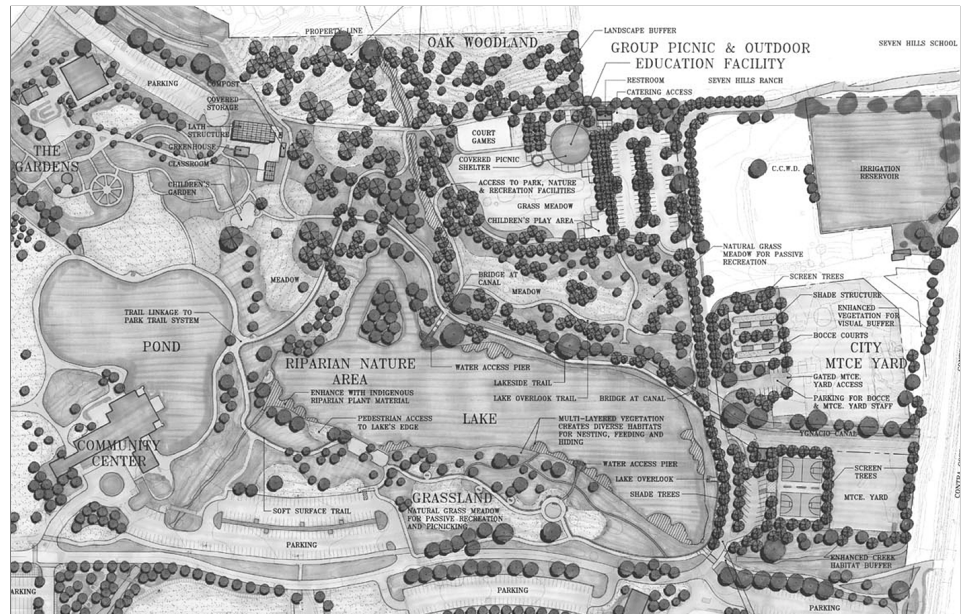

Map shows north end improvements in the revised Heather Farm Park Master Plan, including a larger group picnic area and outdoor education facility, more public access to the lake with piers and pathways, and bocce and basketball courts.

skate park, the rest of the master plan's elements are unfunded. The purpose of the master plan is to establish a vision for the 100-acre park that could be created over the next 15-20 years.



The new skate park at Heather Farm Park will be built on the corner of Heather Drive and Marchbanks Drive, site of the volleyball area.

Applications due Jan. 20 for two City grant fund programs

The City Council is currently soliciting applications for two grant programs: the Community Development Block Grant and Community Services Grant programs.

(Note: The Civic Pride Grant application process will begin later in 2004.)

Community Development Block Grants

The City of Walnut Creek receives funds from the federal government through the Community Development Block Grant (CDBG) program. The City then allocates these funds to support housing, community service, and economic development projects and programs that serve Walnut Creek residents. These funds must be used primarily for the benefit of low and moderate-income persons. In 2004, the City expects to receive approximately \$400,000 in federal grant funds through the CDBG program.

Community Service Grants

To supplement the federal CDBG

funds, the City is making an additional \$100,000 in Community Services grants available to fund projects that benefit the community in the areas of social and human services. These funds are typically used to subsidize public services that do not meet the stringent requirements of the CDBG program.

Applications for both grant programs

are now available. The deadline for submittal is 5 p.m. on Jan. 20. Decisions on which projects are funded will be made by the City Council in the spring.

For details or to obtain an application, contact Laura Simpson at 943-5899 x. 236 or via e-mail at simpson@walnut-creek.org. Applications are also available on-line at www.walnut-creek.org.

Applicants sought for City commissions

As many as three vacancies on City advisory commissions will need to be filled in March, and applications for those seats will be accepted in January.

Commissioners whose second terms will be expiring are Frank Bryant, Planning; Stephen Harriman, Design Review; and William Hunt, Park, Recreation and Open Space.

The City Council is scheduled in January to interview 10 first-term

commissioners whose terms expire in 2004. Appointments will be made in February and new commissioners will be sworn in on March 2.

Applications for remaining vacancies will be accepted from Jan. 7 to 29. Citizens may obtain an application from the City Clerk's Office at City Hall, 1666 No. Main St. by calling 943-5818, or by going on-line to www.walnut-creek.org.

Assistance League volunteers help young and old alike

What may have seemed an ordinary weekday in November was actually more like Christmas Day to dozens of elementary school children who were outfitted with new shirts, pants, and sweatshirts by Assistance League of Diablo Valley volunteers through its Operation School Bell program.

As non-profit philanthropic organizations go, the Assistance League is in, well, a league of its own. And the Diablo Valley chapter, with its more than 460 volunteers, proves that year in and year out with a variety of unique services that benefit young and old alike.

“The Assistance League is project and hands-on oriented, as opposed to fundraising-oriented,” said Carol Roden, public relations/communications chair. “It gives us an opportunity to help our community and pay back a little bit.”

Consider that in the past year, the Assistance League has:

- Provided new clothes for 1,500 children through Operation School Bell
- Granted \$42,000 in scholarships
- Performed 60 puppet shows before more than 4,800 students
- Vision screened 1,400 preschoolers
- Provided emergency clothing to 327 assault victims
- Made 6,680 phone calls to homebound Contra Costa residents

The organization works out of a building at the corner of Buena Vista and Second avenues that has been leased for \$1 a year from the City of Walnut Creek since 1987.

The Assistance League recently began



Jo Spellman, chair of the Operation School Bell clothing program, looks over the inventory.

offering the R.E.A.D. (Read, Enrich, Achieve, Discover) program, in which its volunteers go out to the schools to work with teachers to further the love of reading among children.

There's a youth corps of the Assistance League known as Assisteens, a group of 60 teen-age members in grades 8 through 12 who perform 3-4 hours of community service each month.

Then there's the Telecare program, provided by the Assistance League since 1971, in which volunteers make daily reassurance phone calls Monday through Friday to homebound persons.

“These people who have, perhaps, no one else in their lives have some one checking on them,” said Roden.

Helen Murphy, chair of the Telecare program, has been a member of the

organization for 10 years and loves it.

“It's wonderful,” she said. “To me it's almost like the perfect world.”

In its “perfect” world, the Assistance League runs the popular Wayside Inn Thrift Shop in Lafayette, offers affordable clothing and merchandise to customers who can't afford more, and returns those revenues back to the community through its service programs.

In 2003, the organization put 84 percent of its \$300,000 in total revenues back into the community, said Murphy.

The City has supported the Assistance League with \$12,500 in grants since 2001 for the Operation School Bell clothing program.

To learn more about the Assistance League of Diablo Valley, call 934-0901 or visit www.AssistanceLeagueDV.org.

Walnut Creek: 90 Years of Cityhood

Memories of Gable at Heather Farm

Hollywood came to Walnut Creek in May 1931 when MGM Studio filmed scenes for its feature, *Sporting Blood*, at John Marchbank's Heather Farm thoroughbred facility on Ygnacio Road (home of today's Heather Farm Park).

The star of the film was a young unknown named Clark Gable, portraying a gambler who owned a racehorse named *Sporting Blood*. It was Gable's first starring vehicle (its unappealing original title was *Horse Flesh*). He was so unknown at the time that the *Contra Costa*

Courier-Journal misspelled his name as “Goble.” Only seven years later he was named “The King of Hollywood.”

Legend has it that Gable stayed at the nearby Alexander Lindsay home (today's Seven Hills School) during the two-week filming period. The movie opened at the old Ramona Theatre on Main Street on Sept. 4, 1931.

(Walnut Creek: 90 Years of Cityhood will be an ongoing series this year in observance of the City's 90th anniversary on Oct. 21, 2004.)



Clark Gable and co-star Madge Evans

Public offers valuable input at two workshops

Nearly 70 residents showed up at two public workshops in October to help create a new General Plan by providing valuable insights on what they think is important for the future of Walnut Creek.

The sessions, held Oct. 18 at Heather Farm Park community center and on Oct. 25 at St. Paul's Episcopal Church, were the first in a series of public workshops that will be held over the next two years as the City updates its 1989 General Plan.

Participants broke into small discussion groups to talk about the qualities that make Walnut Creek special to them.

The values that participants stressed the most were Walnut Creek's quality of life (community, culture, recreational opportunities, education, economy), the natural environment (parks, trails, creeks, open space), and the so-called "built environment" (urban design, public art, a vibrant downtown, neighborhoods, historic preservation).

For a complete summary of the

Mt. Diablo Blvd. study to be folded into General Plan

City planners will study ways to enhance the westerly corridor of Mt. Diablo Boulevard from the freeway to California Boulevard as part of the General Plan update.

The City Council on Nov. 18 agreed with staff that the 44-acre area was too large to be the focus of a specific plan, and that it should instead be folded into the General Plan revision currently underway.

Also, the Council directed planners to take a fresh look at the 1995 specific plan for the Mark Morris tire store at the corner of Locust Street and Mt. Diablo Boulevard to see if a new vision is in order for that prominent site.

They will also focus on the Chevron, McDonald's and Big 5 sites at the northeast corner of No. California and Mt. Diablo boulevards.



City planner Jeff Garrigues, right, facilitated a discussion group at the first General Plan public workshop on Oct. 18 at Heather Farm Park community center.



October public workshops, go online to the General Plan Update pages at www.walnut-creek.org/generalplan/default.htm. The next public workshops will be on March 27 and 31.



Oct. 18 workshop participants Carleton Hussey (in glasses) and Jim Scanlon discussed issues around the table with other residents.

Civic Arts Ed celebrates 40th birthday

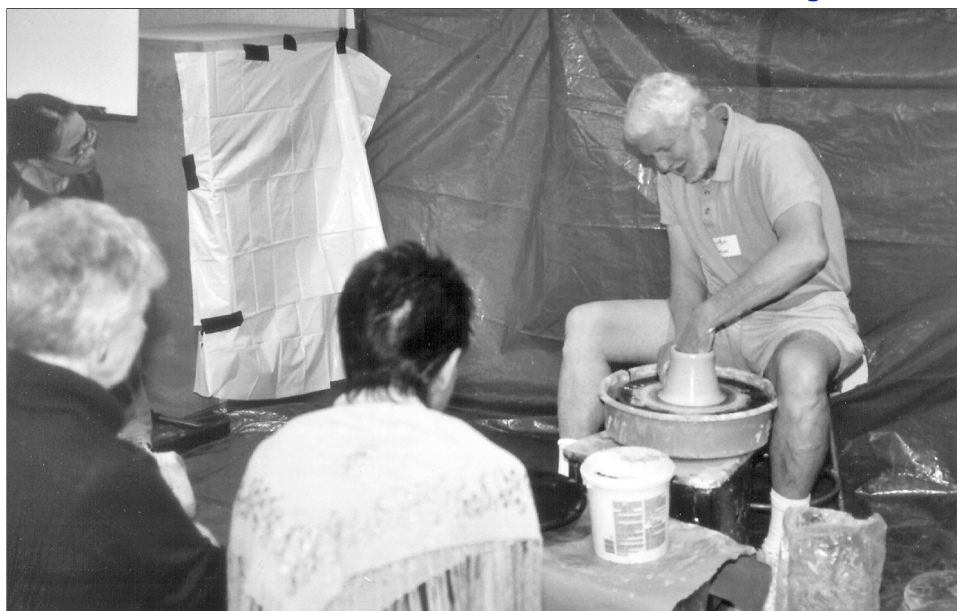

Don Borcella, president of the Clay Arts Guild, demonstrated pottery making on the wheel at the 40th anniversary celebration of the Civic Arts Education program held Oct. 19 at the Shadelands Arts Center, attended by more than 400 well-wishers.

Photo by Dave Hanney

City Council Update

Council OKs Shaping Our Future

The City Council has joined other central Contra Costa County cities in endorsing the Shaping Our Future program, which calls for a regional approach to future growth in the county.

The Council voted unanimously on Nov. 18 to support the principles of program, which calls for the 19 Contra Costa cities to agree on one urban limit line as a shared growth management tool.

The Shaping Our Future principles will also help guide the City as it updates its General Plan over the next two years.

Council members praised the Shaping Our Future program, noting that it will not only benefit Walnut Creek, but the entire county.

Summit Bank design rejected

In an unusual move, the City Council on Nov. 4 sided with Design Review Commissioner Stephen Harriman in overturning the commission's approval of a design for a new Summit Bank at 1716 No. Main Street. Harriman was absent when the commission approved the design on a 2-1 vote on Aug. 20. He appealed the decision to the Council, saying the design is not compatible with the development patterns downtown and is too big for the site. The Council agreed, and sent the matter back to the Design Review Commission for further consideration.

Council to consider rules to require reduced prices on new homes

The City Council in January will consider adopting new rules requiring builders to include new homes and apartments with reduced prices and rents.

Known as "inclusionary zoning," these new requirements will help Walnut Creek meet state goals to provide more affordable housing.

The new rules would require projects of 10 or more housing units to set aside some affordable units for low- and moderate-income families. (A low-income family can earn up to \$64,100 a year; moderate-income families can earn up to \$91,900 a year.)

For housing developments of fewer than 10 units, the builder would have the option of paying a fee to the City in lieu of building affordable units.



Motorists maneuver the City's only traffic roundabout at Walnut Avenue and Oak Grove Road.

Northgate area traffic relief

Council OKs roundabout improvements

The traffic roundabout at the corner of Walnut Avenue and Oak Grove Road will be improved after City traffic staff determined that it has been a successful tool for "calming" traffic in the area.

The City Council on Nov. 4 approved spending \$765,388 to make permanent improvements to the circular intersection, which was installed on a trial basis in April 2002 in an attempt to ease the congestion at the busy neighborhood intersection.

The City installed the roundabout to ease the long traffic back-ups to and from Northgate High School in the mornings and afternoons. The four-block back-ups are a thing of the past as motorists skillfully and confidently maneuver through the roundabout. Although motorists were hesitant at the beginning of the trial period, they soon learned the ins and outs of the roundabout and it has substantially reduced traffic congestion at the busy intersection.

The City took other steps to ease the

back-ups by providing a pedestrian walkway along Castle Rock Road, changing the lane striping, and working with Northgate High officials to better manage the goings and comings at the student parking lot, including a new passenger loading zone.

After tweaking the roundabout to make it larger and easier to drive, City staff concluded that it has reduced overall traffic congestion during peak periods and reduced traffic speeds in the area. Further, there have been no recorded vehicular accidents at the roundabout.

The City Council implemented the Northgate Traffic Calming Project in March 2001 after working for two years with residents in the area in an effort to slow down traffic and improve flow through the neighborhood.

"The result of all the improvements is a safer and more efficient environment for vehicular, pedestrian, and bicycle traffic in the Northgate area," said City traffic engineer Rafat Raie.

Local history focus of WC library talk

The Walnut Creek Library will offer a local author speaker series designed for older adults beginning Jan. 7 with a presentation on the history of Walnut Creek by the City's public information officer, Brad Rovanpera.

These free programs will be in the multipurpose room of the downtown library, 1644 N. Broadway, on the first Wednesday of the month through June,

10:30 a.m. to noon, and are open to all.

The City of Walnut Creek Seniors' Club and the Friends of the Walnut Creek Library, are partnering to sponsor the series, called "Aging Well in Walnut Creek," which is underwritten by Fidelity Investments. A wide range of topics will be presented and the speaker at each program will be a local author. Refreshments will be served at all programs.



By Officer Mike Adams

Are you buckled up?

How do Walnut Creek drivers compare to the rest of California in the compliance with state seatbelt laws? I recently had a conversation with some of my fellow officers regarding this matter, which led me to think that Walnut Creek was well above the average. It prompted me to do a little investigation.



According to the California Office of Traffic Safety (OTS), about 91 percent of drivers wear their seatbelts. I did a little survey of my own to see how the drivers in Walnut Creek compare. I conducted my survey on an average weekday and tried to include a cross section of the community. The survey was limited to drivers only. I found about 87 percent of the drivers were wearing their seatbelts. I was surprised to find that Walnut Creek was below the state average.

Last November, the Walnut Creek Police Department took part in a statewide campaign to provide driver awareness regarding seatbelt use. According to the OTS, the main reason people do not wear their seatbelt is because they forget. They so eloquently named the campaign, "Remember or be Remembered."

The OTS chose to use such slogans as, "Wearing a windshield, now that's uncomfortable" and "safety belts and body bags, one size fits all." I would like to think that we don't need such harsh reminders to buckle up but maybe we do.

Current California law requires that all persons operating a motor vehicle on a highway must wear a seatbelt. The law also provides that all passengers must be restrained as well. This includes children. Any child up to the age of six years or 60 pounds must be restrained by an approved child safety restraint.

If you can't remember to buckle up, the Walnut Creek Police Department has a simple reminder for you. It's called a "ticket." So make 2004 a safe year and choose a reminder that fits, like a seatbelt.



New amphitheater at Borges Ranch

Senior Open Space Ranger Ron White (front, right) recently posed with members of the Rotary Club of Walnut Creek, who built the new 12-by-16-foot amphitheater at Borges Ranch over the summer. The volunteer work crew worked mostly on weekends from June to October to complete the project. They also built the amphitheater at Sugarloaf Open Space last year. The Rotarians who worked on the Borges Ranch project included (front, from left) president Jack Fischer, Allen Wesdorf, Quentin Alexander, and (back, from left) Rod Uffindell, Ross Anderson, Ivan Kerr, Tom Noble, Layton Hansen, Barry Slavin, and Gill Bordenave.

On-line sign-ups near for City rec, art classes

Residents wishing to sign up for Spring 2004 quarter recreation and arts classes will be able to do so on-line for the first time on Feb. 17.

After months of planning and preparation, the Recreation Division and Civic Arts Education will be offering this new "EZ Reg" service to the public. Residents may use the on-line registration to sign up

for any class offered in the spring quarter using a credit card. It will be a faster, easier, more efficient way to register.

On-line registration of classes and programs is the latest in a series of improvements the City has in store this year for its web site, www.walnut-creek.org. Watch future issues of the *Nutshell* for details on what's in store.

More biking? More shopping!

By Larry Mellon
Bicycle Advisory Committee

Walnut Creek boasts many a fine biking trail, but none finer — or more used — than the trail that takes me downtown. You see, I've discovered a secret. On a bicycle, I can park just outside the door: everywhere!

No cruising for meters or climbing garage ramps, hoping to get lucky, just quick and easy access to all that downtown has to offer.

A small backpack suffices as I wander from store to store: occasional overloads

strap nicely to the rear-rack. My refrigerator is as large as downtown: Sunday dinner is whatever looks good that day. Fall clearance sales everywhere? Hit every store in half the time!

But the best part is when Michelle joins me downtown for dinner. While she searches for parking, I've gotten the table. After dinner, we split up: me for my bike,

her for the car. I'm back home with the best cat on my lap — and the TV on my channel — by the time Michelle pulls into the driveway. Next spring: a tandem bicycle!





CLEANING UP THE CREEK — Julia McCartney, 12, a seventh grader at Walnut Creek Intermediate School, pulled a long section of PVC pipe from the waters of Las Trampas Creek during the 14th annual Creek Clean Up Day event on Oct. 4, which was sponsored by the City and the Friends of the Creeks. About 100 volunteers filled two dumpsters with debris.

VLF

From front page

Wilson signed a law to gradually reduce the VLF by 67.5 percent by January 2001. Under the law, the state general fund “backfills” local governments to replace the lost VLF revenues.

By statute, the VLF was to be returned to its pre-1998 level if the state general fund was unable to backfill local governments. Because of the state budget crisis, in summer 2003 the VLF was returned to its original 2 percent rate, which tripled the fee for vehicle owners.

When Governor Schwarzenegger repealed the tripling of the VLF on Nov. 17, he stated that the state would continue to backfill local governments. The state’s financial analyst estimates that through 2004 the backfill commitment will be \$7.6 billion. For every month that state legislators argue this issue without resolution, the City of Walnut Creek will lose \$240,000.

Sadly, the City has reason to be pessimistic regarding the outcome of this issue. The state has a long history of broken promises and revenue grabs that have cost cities and counties countless billions of dollars over the last 25 years, including a property tax takeaway that has cost Walnut Creek \$17 million since 1991.

Council picks new mayor for 2003-2004

The City Council on Dec. 2 selected Charlie Abrams to serve his second term as mayor of Walnut Creek for 2003-2004, succeeding Gwen Regalia.

The Council also picked Gary Skrel to serve as mayor pro tem. He will be in line to become mayor in 2004-2005.

Abrams, a long-time resident of Walnut Creek, was first elected to the City

Council in November 1996 and re-elected November 2000.

A traffic engineering and planning consultant in Walnut Creek, Abrams is a former member of the Planning and Transportation commissions. He is also a former director of the Walnut Creek Chamber of Commerce.

He last served as mayor in 1999-2000.



CITY COUNCIL

Charlie Abrams, Mayor*
Gary Skrel, Mayor pro tem
Kathy Hicks
Sue Rainey
Gwen Regalia

* For appointment: Call 943-5812

ADMINISTRATIVE STAFF

CITY MANAGER
Michael Parness
CITY ATTORNEY
Thomas Haas
CITY CLERK
Barbara Rivara
CITY TREASURER
Ronald Cassano

ADMINISTRATIVE SERVICES
Rosie Coan, Director
COMMUNITY DEVELOPMENT
Valerie Barone, Director
ARTS, RECREATION & COMMUNITY SERVICES
Gary Pokorny, Director
POLICE
Tom Soberanes, Chief of Police
PUBLIC SERVICES
Dan Richardson, Director

IN A Nutshell

Published bi-monthly since 1985
and mailed to
Walnut Creek residents and businesses

Editor:
Brad Rovanpera

We welcome your comments and questions.
Please call 943-5895 or 943-5800
Monday-Friday, 8 a.m. to 5 p.m.

For back issues of the Nutshell, go to www.walnut-creek.org



1666 North Main Street
Walnut Creek, CA 94596

PRESORTED
STANDARD
U.S. POSTAGE
PAID
WALNUT CREEK CA
PERMIT # 282

*****ECRWSS**
POSTAL CUSTOMER