

CITY OF WALNUT CREEK OFF STREET PARKING STANDARDS

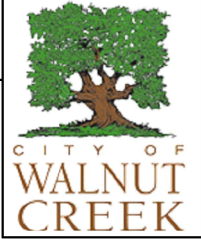

STALL LAYOUT FOR ANGLED PARKING

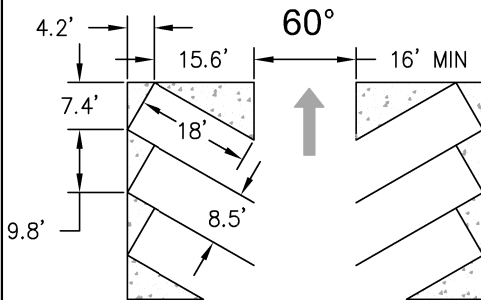
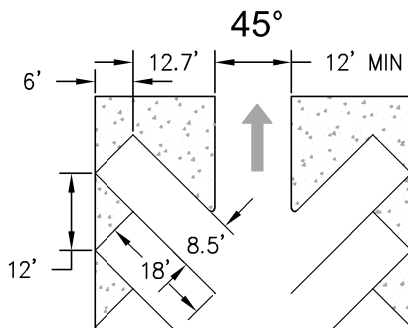
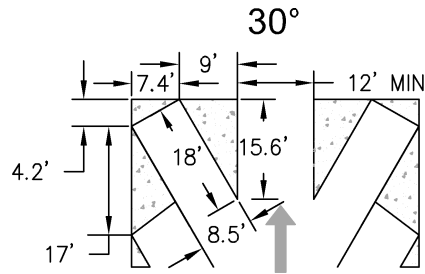

STALL LAYOUT

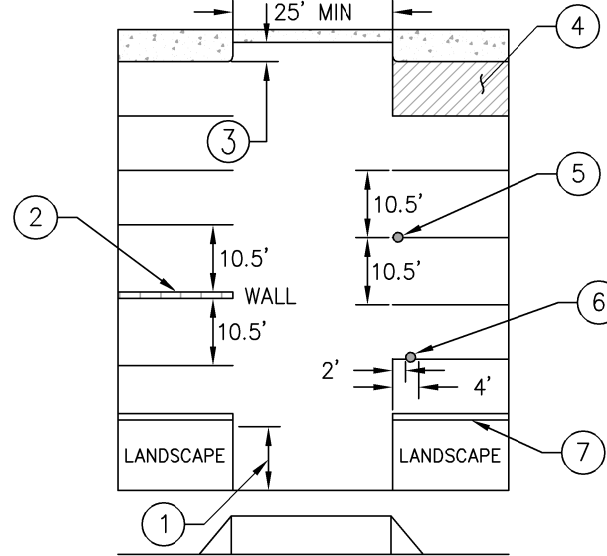

	WIDTH	LENGTH
STANDARD STALL DIMENSIONS	8.5'	18'
STANDARD STALL DIMENSIONS WITH LANDSCAPE OVERHANG	8.5'	15.5'
COMPACT STALL DIMENSIONS	7.5'	15'
COMPACT STALL DIMENSIONS WITH LANDSCAPE OVERHANG	7.5'	13'

- ① THERE SHALL BE A MINIMUM DISTANCE OF 10 FEET FROM THE BACK OF SIDEWALK, PROPERTY LINE, OR BACK OF CURB WHERE THERE IS NO SIDEWALK TO THE FIRST STALL.
- ② STALLS ADJACENT TO WALLS OR SIMILAR STRUCTURE SHALL BE A MINIMUM OF 10.5 FEET WIDE.
- ③ PROVIDE A 3 FOOT NOTCH SPACE AT THE DEAD END OF A DRIVE AISLE
- ④ A HATCHED TURNAROUND STALL SHALL BE PROVIDED FOR DEAD END AISLES.
- ⑤ WHEN A COLUMN IS LOCATED LESS THAN 2 FEET FROM THE TAIL END OF A STALL, THE PARKING STALL SHALL BE A MINIMUM OF 10.5 FEET WIDE.
- ⑥ COLUMN IS TO BE LOCATED BETWEEN 2 FEET AND 4 FEET TO MAINTAIN A STANDARD 8.5 FOOT WIDE STALL DIMENSION.
- ⑦ IT IS RECOMMENDED TO PROVIDE A 1 FOOT CONCRETE BAND WHEN A PARKING STALL IS ADJACENT TO A LANDSCAPED AREA.

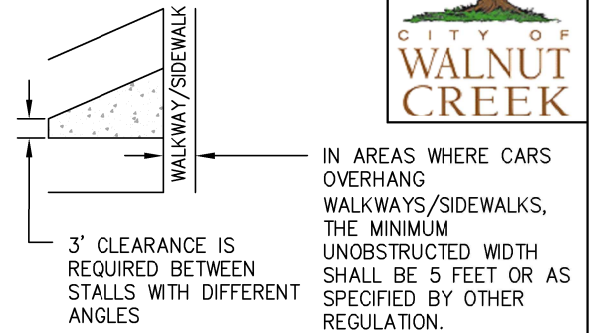

NOTES:

GENERAL:

1. COVERED PARKING SPACES FOR SINGLE FAMILY HOMES ARE 9'X20' FOR A SINGLE SPACE AND 18'X20' FOR TWO SPACES.
2. LANDSCAPE OVERHANGS ARE NOT INTENDED TO DEFINE THE LOCATION OF WHEEL STOPS.
3. ALL TWO-WAY AISLES SHALL BE A MINIMUM OF 20 FEET WIDE EXCEPT FOR 90 DEGREE PARKING WHERE AISLES SHALL BE A MINIMUM OF 25 FEET WIDE.
4. ALL PARKING LOTS SHALL BE DESIGNED AND MAINTAINED IN SUCH A WAY THAT VEHICLES DO NOT OVERHANG OR PARK IN THE PUBLIC RIGHT-OF-WAY, OR USE PUBLIC RIGHT OF WAY FOR BACKING OUT OF STALLS (I.E. BACK OUT OF A STALL INTO THE STREET OR ACROSS A SIDEWALK).

COMPACT STALLS:

5. COMPACT STALLS ARE ALLOWED ONLY FOR BUSINESS & PROFESSIONAL OFFICE USE WHERE MORE THAN 10 SPACES ARE REQUIRED.
6. EXISTING COMPACT STALLS FOR OTHER USES MAY REMAIN IF THERE ARE STRUCTURAL CONSTRAINTS OR IF CONVERTING TO STANDARD STALLS WOULD REDUCE THE NUMBER OF STALLS TO BELOW THE MINIMUM REQUIRED.

REVISED: JUNE 2018

REFER TO W.C.M.C. SECTION 10-2.3.206 IN THE ZONING ORDINANCE FOR ADDITIONAL NOTES