

SIGN APPLICATION

Community Development Department, Planning Division
 1666 North Main Street, P.O. Box 8039
 Walnut Creek, CA 94596
 (925) 256-3558 information (925) 256-3500 fax
www.walnut-creek.org/website

*For Staff Use Only
(Date Stamp)*

Sign Review # SR10.038
 Work Order #: _____
 Parcel Map #: _____
 Total Deposit/Fee: \$ 300.00
 Receipt #: _____
 Received By: Jelena

APPLICANT: PLEASE PRINT CLEARLY AND FILL IN ALL APPLICABLE SECTIONS

I. Site Information

Business Name: Grubbs & Ellis Business Address/Sign Location: 500 yuma
 Nature of business or use of sign(s): real estate
 Ground floor area of business: _____ sq. ft.
 Ground floor principal frontage of business/tenant space: _____ ft.
 Area of property: _____ sq. ft. Sign Program: Yes No

II. Sign Information

Sign area of all existing signs to remain: _____ sq. ft. _____ sq. ft. _____ sq. ft. _____ sq. ft.
 Total sign area of proposed and existing signs to remain on principal frontage: _____ sq. ft.
 Sign area on each other frontage: _____ sq. ft. _____ sq. ft. _____ sq. ft.
 Type and number of proposed signs:
 Wall/Fascia _____ Freestanding/Monument: _____ Blade: _____ Awning Copy: _____
 Illumination: Internal Neon/Fluorescent Indirect Spot/Flood Lights Halo/Backlit None

III. Complete the following as it relates to each proposed sign:

Sign #	Dimensions		Mounting or Support	Type, spacing & specs	Material
	Vertical	Horizontal			
1	20"	16' 7"	Post mount slab	1/2 spacing	Aluminum

PROPERTY OWNER OR AGENT AUTHORIZATION:

NAME: Pat Meloni
 COMPANY: Corporate Brokerage
 ADDRESS: 2255 Moreland Ave # 220
 CITY, STATE: Pleasant Hill ZIP: 94523
 PHONE #: 925-588-1175 FAX #: _____
 EMAIL: pat @ corporatebrokerage.com

CHOOSE ONE:

- I am the property owner and hereby authorize the filling of this application.
- I am the applicant and am authorized by the owner to file this application.

SIGNATURE: Pat Meloni
 DATE: July 2 2010

29 SF FT TOTAL

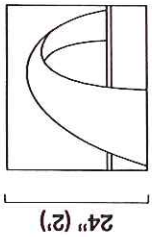

24" (2')

GRUBB & ELLIS

28" (2' 4")

195" (16' 3")

235" (19' 7")

Proposed Signage

Letter wt 1.5 lbs
Logo wt 4 lbs

Letters:

2" deep fabricated steel, with a silver satin finish, .5" offset from fascia.
Matte vinyl used on block where shown. Matte vinyl color TBD.

Mounting:

Pad Mounts: .25" x .083" threaded discs attached to mounting stud. Adhesive for granite.

1 1/2" pad mount 4 per letter & per logo - ea. 10# shear wt

Specifications

SR 10-038

CITY OF WALNUT CR
CONSULTING ENGINEERING DEPARTMENT
SIGN APPROVED

PLANNING: AS CORRECTED

Per plan 7210 Scale: .375" = 1'
Date

Design Review Date
PER CONDITIONS OF GRANT

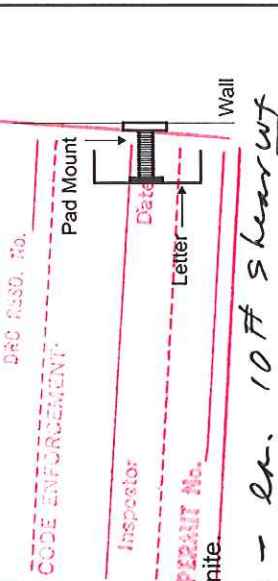

Corporate Graphics

2255 Morello Ave.
Suite 220
Pleasant Hill, CA 94523
Tel: 925.933.7457
Fax: 925.933.7491
www.CorpGraphics.com

License #811422

Client:
Grubb & Ellis

Project Location(s):
500 Ygnacio Valley Road,
Walnut Creek, CA 94596

Date: 05-19-10
Revision: 5
Drawn by: James Marshall
Scale: see above
Page #: 1
Job #:
File Location: jwm/mc/gc

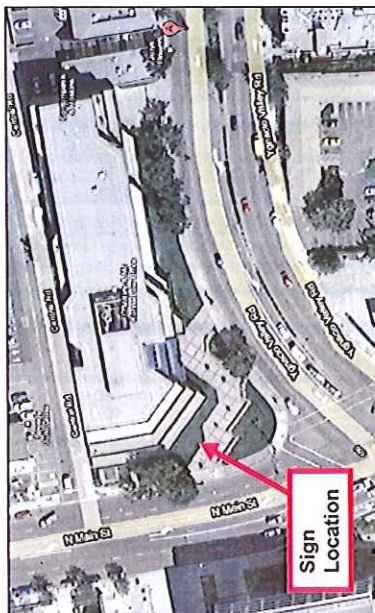

Site Map

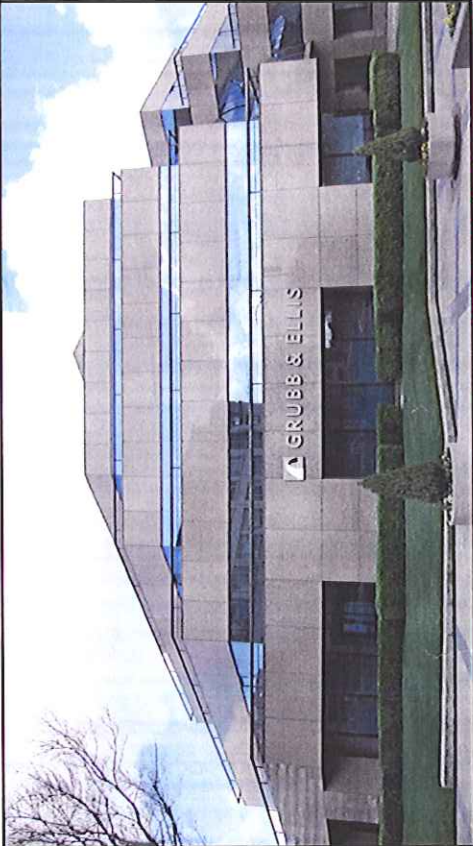

Elevation

O.K. AS REPLACEMENT OF PREVIOUS
OCE SIGN AT THIS LOCATION

Per plan 7210
CC C-45 811422

24" (2) [Logo] GRUBB & ELLIS [Logo] 18" (1.8)

28" (2' 4") 195" (16' 3") 235" (19' 7")

Scale: 3/8" = 1'

APPROVED BY UNAD LOPEZ
Andre Herring 6/16/10

Proposed Signage

Letters:

2" deep fabricated steel, with a silver satin finish. .5" offset from fascia.
 Matte vinyl used on block where shown. Matte vinyl color TBD.

Mounting:

Pad Mounts: .25" x .083" threaded discs attached to mounting stud. Adhesive for granite.

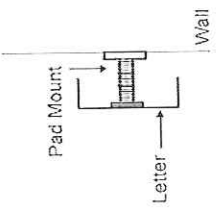

Specifications

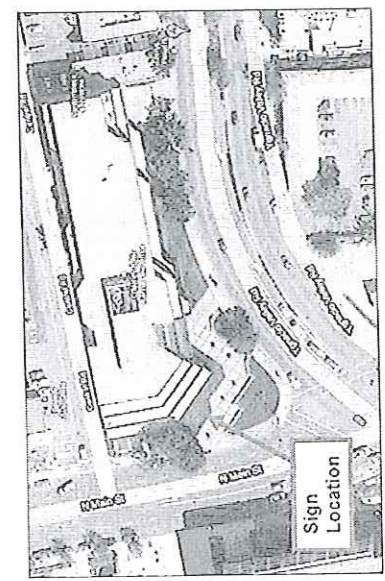

Site Map

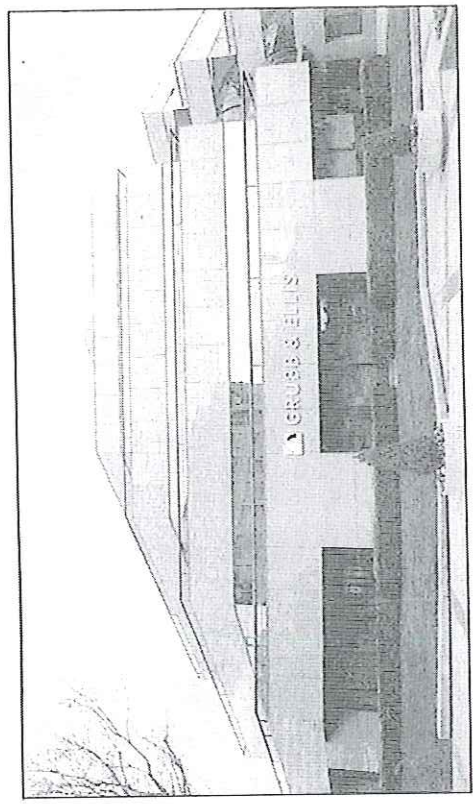

Elevation

ANDRÉ D. HERRING
 Vice President, Asset Management

3000 Executive Parkway, Suite 236
 San Ramon, CA 94583
 (925) 866-9648
 (925) 866-8168 fax
 aherring@paceagle.com

Client: Grubb & Ellis	Project Location(s): 500 Ygnacio Valley Road, Walnut Creek, CA 94596	Date: 05-19-10 Revision: 5 Drawn by: James Marshall Scale: see above Page #: 1 Job #: File Location: jvm/mc/ge
---------------------------------	---	---

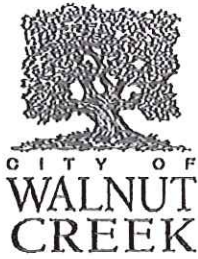

SIGN APPLICATION

Community Development Department, Planning Division
 1666 North Main Street, P.O. Box 8039
 Walnut Creek, CA 94596
 (925) 256-3558 information (925) 256-3500 fax
 www.walnut-creek.org website

For Staff Use Only
 (Date Stamp)

Sign Review # SR11-005
 Work Order #: _____
 Parcel Map #: _____
 Total Deposit/Fee: \$ 300
 Receipt #: 233796
 Received By: [Signature]

APPLICANT: PLEASE PRINT CLEARLY AND FILL IN ALL APPLICABLE SECTIONS

I. Site Information

Business Name: OLD REPUBLIC TITLE Business Address/Sign Location: 500 YENACIO VALLEY RD.
 Nature of business or use of sign(s): TITLE COMPANY WALL SIGN
 Ground floor area of business: 3694 sq. ft.
 Ground floor principal frontage of business/tenant space: 75 ft.
 Area of property: 105,495 sq. ft. Sign Program: Yes No

II. Sign Information

Sign area of all existing signs to remain: 30 sq. ft. sq. ft. sq. ft. sq. ft.
 Total sign area of proposed and existing signs to remain on principal frontage: 45 sq. ft.
 Sign area on each other frontage: sq. ft. sq. ft. sq. ft.

Type and number of proposed signs:

Wall/Fascia 1 Freestanding/Monument: Blade: Awning Copy:
 Illumination: Internal Neon/Fluorescent Indirect Spot/Flood Lights Halo/Backlit None
BY OTHERS

III. Complete the following as it relates to each proposed sign:

Sign #	Dimensions		Mounting or Support	Type, spacing & specs	Material
	Vertical	Horizontal			
1	12"	15'	SILICON ADHESIVE	REVERSE CUT OUT LETTERS	STEEL

PROPERTY OWNER OR AGENT AUTHORIZATION:

NAME: ANDRE HERRING
 COMPANY: PACIFIC ENERGY HOLDINGS
 ADDRESS: 3000 EXECUTIVE PARKWAY #236
 CITY, STATE: SAN RAMON, CA ZIP: 94583
 PHONE #: 925-866-9648 FAX #: 925-866-8468
 EMAIL: AHERRING@PACENERGY.COM

CHOOSE ONE:

- I am the property owner and hereby authorize the filling of this application.
 I am the applicant and am authorized by the owner to file this application.

SIGNATURE: [Signature]
 DATE: 4/5/11

OLD REPUBLIC TITLE CO
500 YGNACIO VALLEY ROAD
WALNUT CREEK, CA

15' - 0"

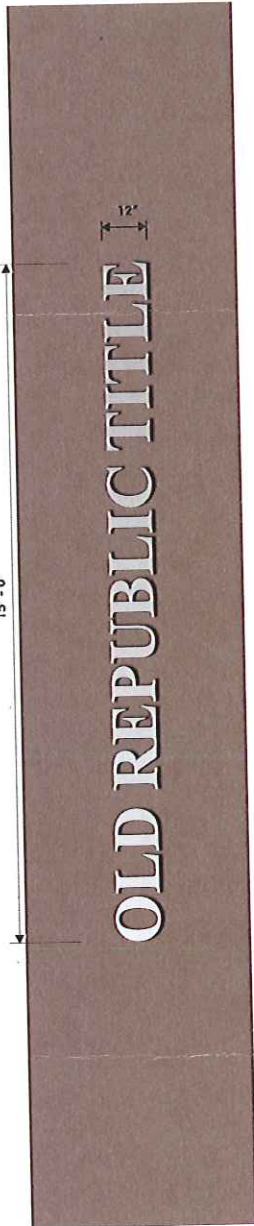

60" FASCIA (EST.)

SCALE 3/8" = 1'

15sf

FIELD SURVEY REQUIRED PRIOR TO FABRICATION

LETTERS: FABRICATED STEEL, WITH SILVER SATIN FINISH, 1 1/2" DEEP PAD MOUNTS; PEGGED 1/2" OFF SURFACE, USING PADS AND GE 1000 SERIES SILICON ADHESIVE FOR GRANITE

THE SIGN WILL BE ILLUMINATED BY A SPOT LIGHT INSTALLED IN THE LANDSCAPING (BY OTHERS).*



PAD MOUNT WITH SILICON ADHESIVE FOR GRANITE

ELEVATION

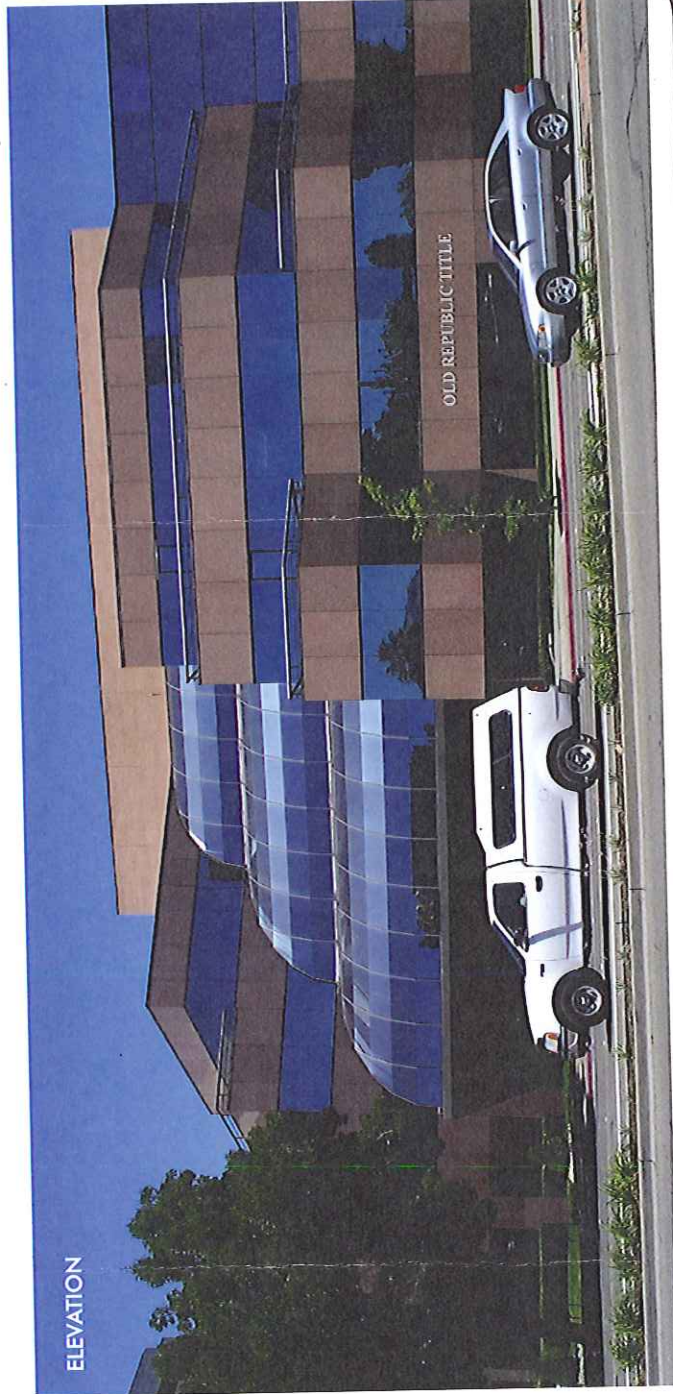

6221 Enterprise Drive Diamond Springs, CA 95610
Phone 916 833-3785 • 530 622-1420 • Fax 530 622-9367

SALESPERSON: Todd Johnston
ILLUSTRATION: Perry Wilson
LOCATION: Walnut Creek, CA 94596
REVISED: 10/14/10

CUSTOMER APPROVAL: _____ DATE: _____
LANDLORD APPROVAL: _____ DATE: _____
COLORS ON THIS PRINTOUT MAY VARY SLIGHTLY FROM FINAL MATERIALS COLORS. APPROVAL OF THIS PRINTOUT DOES NOT CONSTITUTE AN ENDORSEMENT OR GUARANTEE OF THE PRODUCT OR THE ILLUSTRATION. THE ILLUSTRATION INCLUDES APPROVAL OF THE FINAL MATERIALS COLORS AS REFERENCED IN THE CALLOUT. WRITTEN DIMENSIONS ON THIS ILLUSTRATION HAVE PRECEDENCE OVER CALLED DIMENSIONS.
SALESPERSON SIGNOFF: _____

PERMITS OF THE CITY OF WALNUT CREEK
PLANS APPROVED
PERMIT NO. SR11-005 DATE: 2/8/11
BY: Scott Jensen

THIS IS AN ORIGINAL UNPUBLISHED DRAWING CREATED BY WESTERN SIGN CO., INC. IT IS SUBMITTED FOR YOUR APPROVAL. IT IS NOT TO BE SHOWN TO ANYONE OUTSIDE YOUR ORGANIZATION, NOR IS IT TO BE REPRODUCED, COPIED, OR EXHIBITED IN ANY FASHION WITHOUT EXPRESSED WRITTEN PERMISSION OF WESTERN SIGN CO., INC.

OLD REPUBLIC TITLE CO
500 YGNACIO VALLEY ROAD
WALNUT CREEK, CA

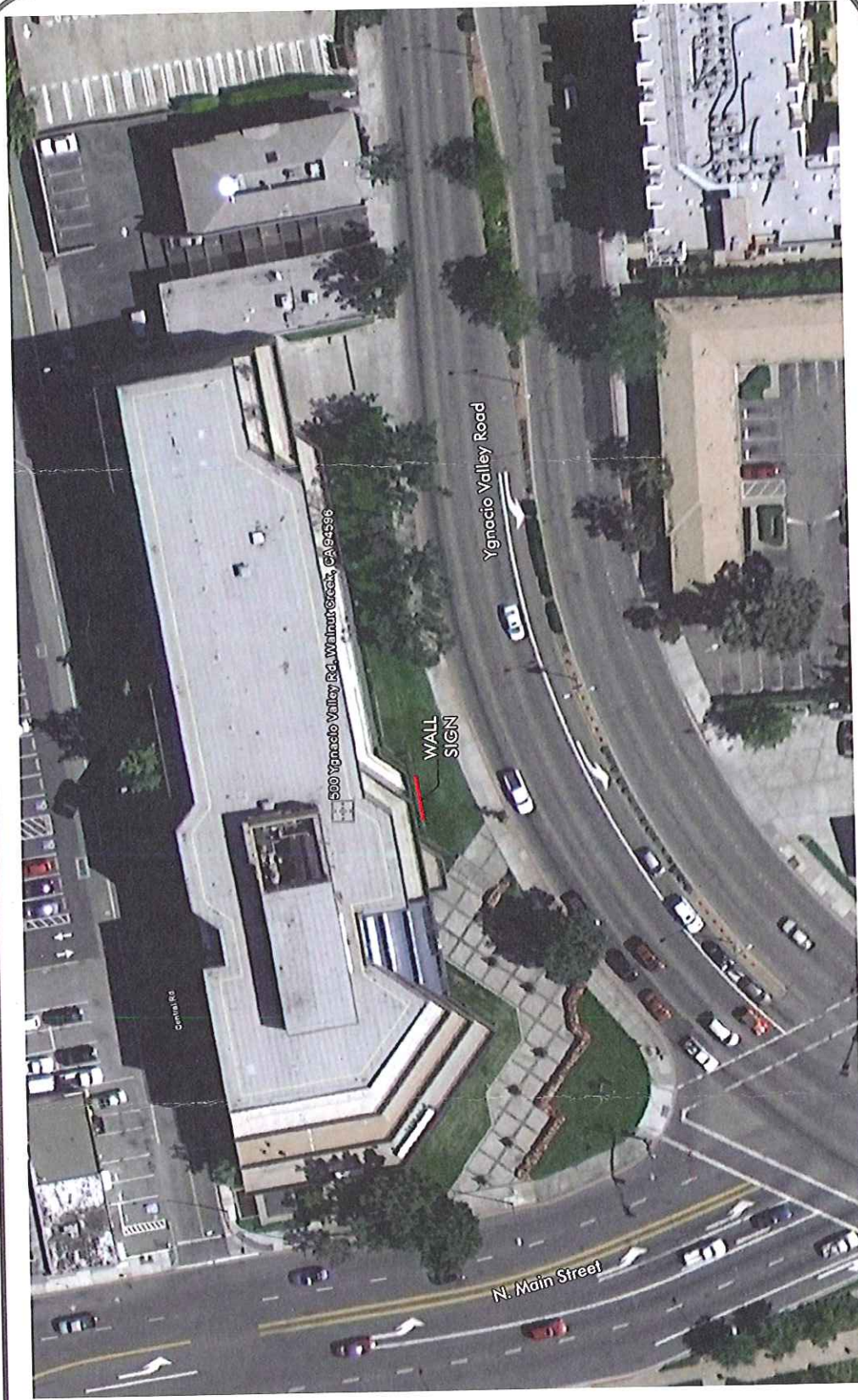

6221 Enterprise Drive Diamond Springs, CA 95610
Phone 916 833-3765 - 530 622-1420 - Fax 530 622-9367

THIS IS AN ORIGINAL UNPUBLISHED DRAWING CREATED BY WESTERN SIGN CO., INC. IT IS SUBMITTED FOR YOUR APPROVAL. IT IS NOT TO BE SHOWN TO ANYONE OUTSIDE YOUR ORGANIZATION, NOR IS IT TO BE REPRODUCED, COPIED OR EXHIBITED IN ANY FASHION WITHOUT EXPRESSED WRITTEN PERMISSION OF WESTERN SIGN CO., INC.

SALESPERSON Todd Johnson
ILLUSTRATION Perry Wilson
LOCATION Walnut Creek, CA
REVISED 06/25/10
101-410

CUSTOMER APPROVAL _____ DATE _____
LANDLORD APPROVAL _____ DATE _____
COLORS ON THIS PRINTOUT MAY VARY SLIGHTLY FROM FINAL MATERIALS COLORS. APPROVAL OF THIS ILLUSTRATION INCLUDES APPROVAL OF THE FINAL MATERIALS COLORS AND OVERSIZED DIMENSIONS. CALLOUT. WRITTEN DIMENSIONS ON THIS ILLUSTRATION HAVE PRECEDENCE OVER CALLED DIMENSIONS.
SALESPERSON SIGNOFF _____ DATE _____



CITY OF WALNUT CREEK

PLANS APPROVED

PERMIT No. SR11-005 DATE 2/8/11

BY: Scott Hinson